

CoolLED

PRO

Premium LED DRIVERS

Unlock your product potential with the NEW CLi series

- Ultra Low Flicker
- Low Dimming to 0.1%
- Smooth Dim to Off
- 100-1400mA Programmable
- Power Range 1W to 40W
- Wireless Control Options
- Corridor & Push Dim Function



Constant Current | High Performance | Flexible Design | Programmable
Compact Design | Superior Light Quality

ULTRA

LOW
DIMMING

FLICKER
FREE

SMOOTH
DIMMING

COMPACT

PRO

5 YEAR
WARRANTY

- Fits through a 40mm hole.
- Supports from as low as 1 single LED.
- Isolated output.
- Smooth dimming to 0.1%.
- Touch/push-to-dim function as standard.
- Corridor/Switch dim function as standard.
- Exceptionally low LED flicker
Near perfect light quality.
- Wireless ready
Contact us for further information.

CLi 15 DALI/Touch/Corridor Dimmable

15W

Part number	Programmable Current Range	LED String Voltage	Max. Tc Temperature	Ambient Temperature Range	Thermal Trip (Self - resetting)	Maximum Power	Power factor at full load	Efficiency at full load	Minimum Dimmed Current
CLi15-D01-240/xxxx	100 - 1050mA (±5)	2.5V to 38V	80°C	-25 - 50°C	100°C	15W	0.97	85%	1mA
CLi15-D02-240/xxxx	100 - 700mA (±5)	4.5V to 52V	80°C	-25 - 50°C	100°C	15W	0.97	85%	1mA
CLi15-D05-240/xxxx	100 - 1050mA (±5)	2.5V to 38V	80°C	-25 - 50°C	100°C	15W	0.97	85%	350µA
CLi15-D06-240/xxxx	100 - 700mA (±5)	4.5V to 52V	80°C	-25 - 50°C	100°C	15W	0.97	85%	350µA

CLi 15 0-10V/1-10V Analogue Dimmable

15W

Part number	Programmable Current Range	LED String Voltage	Max. Tc Temperature	Ambient Temperature Range	Thermal Trip (Self - resetting)	Maximum Power	Power factor at full load	Efficiency at full load	Minimum Dimmed Current
CLi15-A01-240/xxxx	100 - 1050mA (±5)	2.5V to 38V	80°C	-25 - 50°C	100°C	15W	0.97	85%	350µA
CLi15-A02-240/xxxx	100 - 700mA (±5)	4.5V to 52V	80°C	-25 - 50°C	100°C	15W	0.97	85%	350µA

ULTRA COMPACT

Dimensions



Built in

(without cable clamps/covers)

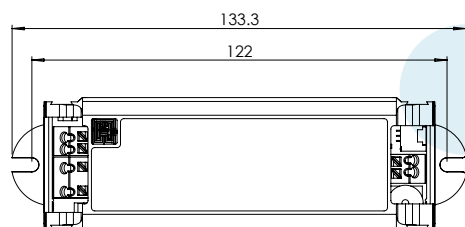

Independent

(with cable clamps/covers for remote application)

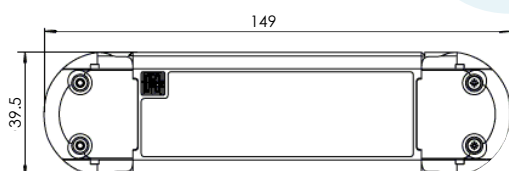

Cable clamps/covers part number CLi-CC39-SET

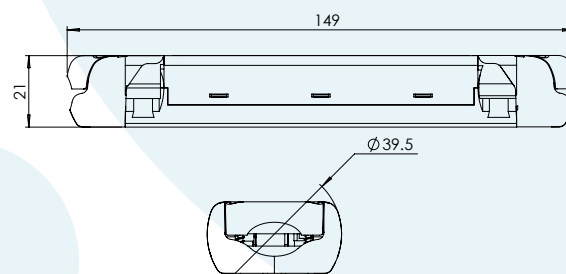
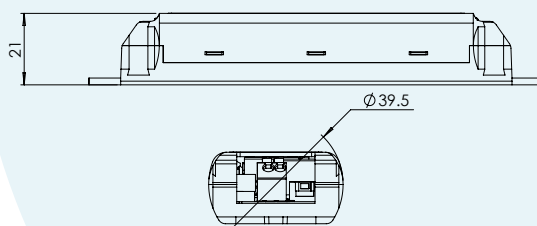

CoolLED

PRO

25W/40W

CB
Scheme

- Fits through a 56mm hole.
- Supports from as low as 1 single LED.
- Isolated output.
- Smooth dimming to 0.1%.
- Touch/push-to-dim function as standard.
- Corridor/Switch dim function as standard.
- Exceptionally low LED flicker
- Near perfect light quality.
- Wireless ready
- Contact us for further information.

CLi 25 DALI/Touch/Corridor Dimmable

25W

Part number	Programmable Current Range	LED String Voltage	Max. Tc Temperature	Ambient Temperature Range	Thermal Trip (Self - resetting)	Maximum Power	Power factor at full load	Efficiency at full load	Minimum Dimmed Current
CLi25-D02-240/xxxx	100 - 1050mA (±5)	4.5V to 52V	85°C	-25 - 50°C	100°C	25W	0.98	87%	350µA

CLi 25 0-10V/1-10V Analogue Dimmable

25W

Part number	Programmable Current Range	LED String Voltage	Max. Tc Temperature	Ambient Temperature Range	Thermal Trip (Self - resetting)	Maximum Power	Power factor at full load	Efficiency at full load	Minimum Dimmed Current
CLi25-A02-240/xxxx	100 - 1050mA (±5)	4.5V to 52V	85°C	-25 - 50°C	100°C	25W	0.98	87%	350µA

CLi 40 DALI/Touch/Corridor Dimmable

40W

Part number	Programmable Current Range	LED String Voltage	Max. Tc Temperature	Ambient Temperature Range	Thermal Trip (Self - resetting)	Maximum Power	Power factor at full load	Efficiency at full load	Minimum Dimmed Current
CLi40-D01-240/xxxx	100 - 1400mA (±5)	2.5V to 38V	85°C	-25 - 50°C	100°C	40W	0.98	87%	350µA
CLi40-D02-240/xxxx	100 - 1050mA (±5)	4.5V to 52V	85°C	-25 - 50°C	100°C	40W	0.98	88%	350µA

CLi 40 0-10V/1-10V Analogue Dimmable

40W

Part number	Programmable Current Range	LED String Voltage	Max. Tc Temperature	Ambient Temperature Range	Thermal Trip (Self - resetting)	Maximum Power	Power factor at full load	Efficiency at full load	Minimum Dimmed Current
CLi40-A01-240/xxxx	100 - 1400mA (±5)	2.5V to 38V	85°C	-25 - 50°C	100°C	40W	0.98	87%	350µA
CLi40-A02-240/xxxx	100 - 1050mA (±5)	4.5V to 52V	85°C	-25 - 50°C	100°C	40W	0.98	88%	350µA

ULTRA COMPACT

Dimensions



Built in
(without cable clamps/covers)

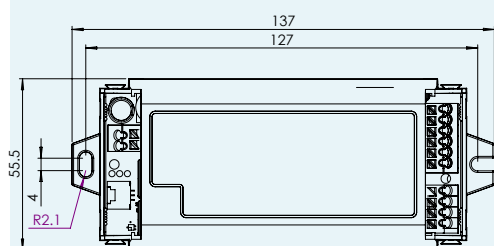

Independent
(with cable clamps/covers for remote application)

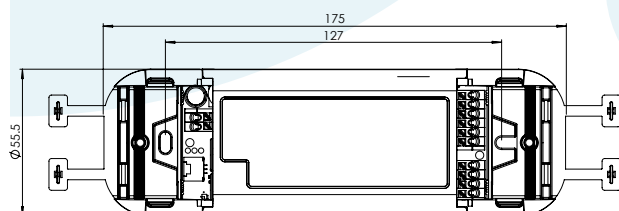

Cable clamps/covers part number CLi-CC55-SET

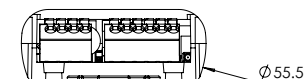
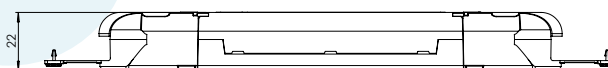
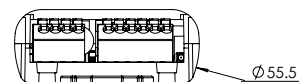
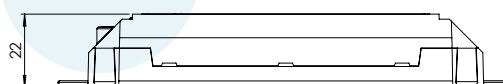
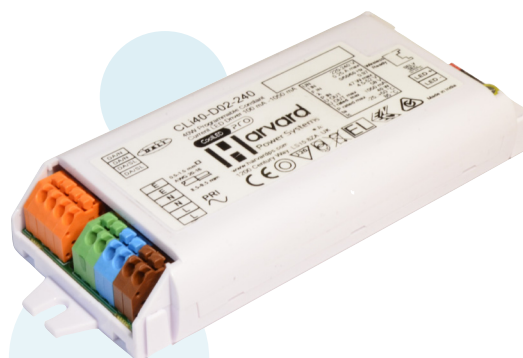

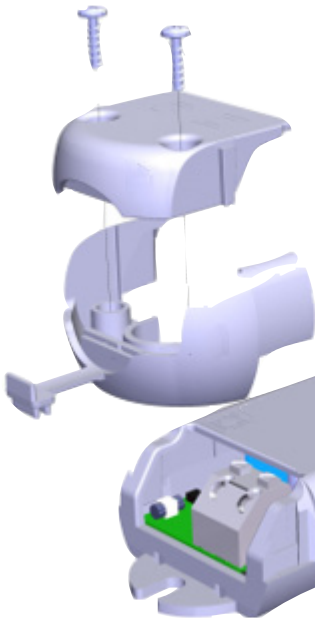

Flexible Design

One driver – Multiple applications

- Independent compliance with easy fit cable clamps/covers.
- Accommodates multiple cable entry
- Suitable for all cable diameters up to 7mm

PC Interface to set up a driver profile

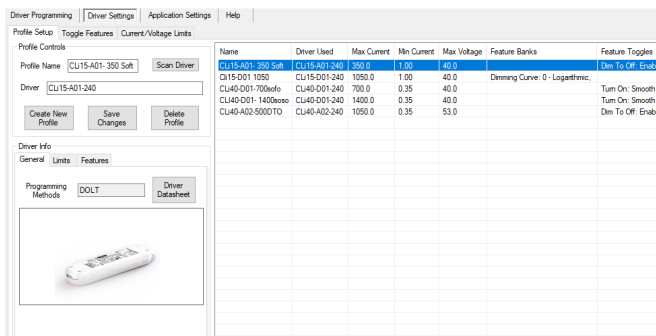

Fully Programmable

One driver – Multiple applications

- Output current programmable in 1mA step increments from as low as 100mA to 1400mA
- Wide operating voltage range from 2.5Vdc to 52Vdc
- Programmable smooth ON and fade to OFF

Key Features

Reliability

Extended life testing gives confidence and reliability for installations for years to come.

Mains Smoothing

Protection from mains supply variation, enhanced EMC performance and LED light purity.

Performance

Highly efficient two stage circuit design providing 88-90% efficiency; smoothed input supply and low dc output ripple.

DALI

Mains tolerant protection.
Touch/push-to dim, Corridor & Switch dimming.

Emergency operations

AC/DC operation make it compatible for Emergency applications in accordance with EN61347-2-13 Annex J.

Low Noise

Extremely low audible noise measured below 20dBA make it perfect for both home and commercial applications.

